

Danilo Araujo
Waterman Moylan
Block S, Easpoint
Business Park
Alfie Byrne Road
Dublin
D03H3F4

Uisce Éireann
Bosca OP 448
Oifig Sheachadta na
Cathrach Theas
Cathair Chorcaí

Uisce Éireann
PO Box 448
South City
Delivery Office
Cork City

www.water.ie

6 February 2025

**Re: Design Submission for Independent House, 90 Middle, North City, Dublin (the “Development”)
(the “Design Submission”) / Connection Reference No: CDS24004395**

Dear Danilo Araujo,

Many thanks for your recent Design Submission.

We have reviewed your proposal for the connection(s) at the Development. Based on the information provided, which included the documents outlined in Appendix A to this letter, Uisce Éireann has no objection to your proposals.

This letter does not constitute an offer, in whole or in part, to provide a connection to any Uisce Éireann infrastructure. Before you can connect to our network you must sign a connection agreement with Uisce Éireann. This can be applied for by completing the connection application form at www.water.ie/connections. Uisce Éireann's current charges for water and wastewater connections are set out in the Water Charges Plan as approved by the Commission for Regulation of Utilities (CRU) (https://www.cru.ie/document_group/irish-waters-water-charges-plan-2018/).

You the Customer (including any designers/contractors or other related parties appointed by you) is entirely responsible for the design and construction of all water and/or wastewater infrastructure within the Development which is necessary to facilitate connection(s) from the boundary of the Development to Uisce Éireann's network(s) (the “**Self-Lay Works**”), as reflected in your Design Submission. Acceptance of the Design Submission by Uisce Éireann does not, in any way, render Uisce Éireann liable for any elements of the design and/or construction of the Self-Lay Works.

If you have any further questions, please contact your Uisce Éireann representative:

Name: Alicia Ros Bernal

Email: ailciarosbernal.bernal@water.ie

Yours sincerely,



Dermot Phelan
Connections Delivery Manager

Stiúrthóirí / Directors: Niall Gleeson (POF / CEO), Jerry Grant (Cathaoirleach / Chairperson), Gerard Britchfield, Liz Joyce, Michael Nolan, Patricia King, Eileen Maher, Cathy Mannion, Paul Reid, Michael Walsh.

Oifig Chláraithe / Registered Office: Teach Colvill, 24-26 Sráid Thalbóid, Baile Átha Cliath 1, D01 NP86 / Colvill House, 24-26 Talbot Street, Dublin, Ireland D01NP86

Is cuideachta ghníomhaíochta ainmnithe atá faoi theorainn scaireanna é Uisce Éireann / Uisce Éireann is a designated activity company, limited by shares. Cláraithe in Éirinn Uimh.: 530363 / Registered in Ireland No.: 530363.

Appendix A

Document Title & Revision

- 24-036-P200 - Proposed Ground Floor Drainage Layout-.
- 24-036-P210 - Proposed Basement Drainage Layout-.
- 24-036-P300 - Proposed Watermain Layout-.

Additional Comments

Meter arrangements shall be reviewed at connection application stage.

The design submission will be subject to further technical review at connection application stage.

Uisce Éireann cannot guarantee that its Network in any location will have the capacity to deliver a particular flow rate and associated residual pressure to meet the requirements of the relevant Fire Authority, see Section 1.17 of Water Code of Practice.

For further information, visit www.water.ie/connections

Notwithstanding any matters listed above, the Customer (including any appointed designers/contractors, etc.) is entirely responsible for the design and construction of the Self-Lay Works. Acceptance of the Design Submission by Uisce Éireann will not, in any way, render Uisce Éireann liable for any elements of the design and/or construction of the Self-Lay Works.

NOTES:

- DO NOT SCALE. USE FIGURED DIMENSIONS ONLY.
- THIS DRAWING IS TO BE READ IN CONJUNCTION WITH ALL OTHER RELEVANT ARCHITECTURAL AND ENGINEERING DRAWINGS.
- DRAINAGE DESIGN IS IN ACCORDANCE WITH:
 - RECOMMENDATIONS FOR SITE DEVELOPMENT WORKS FOR HOUSING AREAS PUBLISHED IN 1998;
 - GREATER DUBLIN STRATEGIC DRAINAGE STUDY (INCLUDING ATTENUATION OF SURFACE WATER FLOWS WHERE SPECIFIED);
 - BUILDING REGULATIONS;
 - CIVIL ENGINEERING SPECIFICATION FOR THE WATER INDUSTRY (CESWI);
 - IRISH WATER CODE OF PRACTICE FOR WASTEWATER INFRASTRUCTURE; AND
 - IRISH WATER CODE OF PRACTICE FOR WATER INFRASTRUCTURE.

LEGEND

- SITE BOUNDARY
- F1
CL 7.16
IL 5.15
150mm Ø @ 1:200
- PROPOSED DUCTILE IRON FOUL WATER SEWER WITH PIPE SIZE, GRADE, MANHOLE REF. AND INVERT LEVEL SUSPENDED FROM GROUND FLOOR SLAB
- S1
CL 7.16
IL 5.15
225mm Ø @ 1:200
- PROPOSED DUCTILE IRON SURFACE WATER SEWER WITH PIPE SIZE, GRADE, MANHOLE REF. AND INVERT LEVEL SUSPENDED FROM GROUND FLOOR SLAB
- F1
CL 7.16
IL 5.15
225mm Ø @ 1:200
- INDICATES PROPOSED COMBINED FOUL SEWER WITH PIPE SIZE, GRADE, MANHOLE REF. AND INVERT LEVEL
- EX FMH
CL 0.00
IL 0.00
225mm Ø @ 1:200
- INDICATES EXISTING COMBINED SEWER

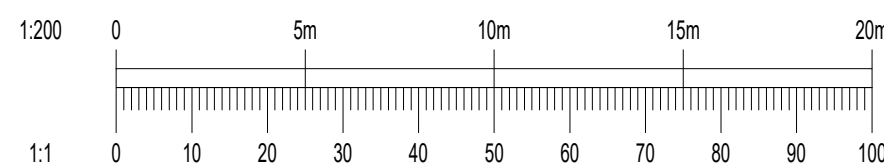

Rev	Date	Description	By	Chk
Amendments				

Project
Independent House Student Accommodation
Middle Abbey Street
Dublin 1

Title
**PROPOSED GROUND FLOOR
DRAINAGE LAYOUT**

Client
SUMMIX IHD DEVELOPMENT LIMITED



BLOCK S, EASTPOINT BUSINESS PARK, ALFIE BYRNE ROAD,
DUBLIN D03 H3F4 IRELAND. Tel: (01) 664 8900
Email: info@waterman-moylan.ie www.waterman-moylan.ie

Status
FOR PLANNING ONLY

Designed By	BL	Approved	BG	Waterman Ref	24-036
Drawn By	VU	Date	NOV. 2024	Scales @ A1	1:200 @ A1

Project	Originator	Volume	Level	Type	Role	Number	Revision
---------	------------	--------	-------	------	------	--------	----------

IHSA - WMC - ZZ - XX-DR- C - P200

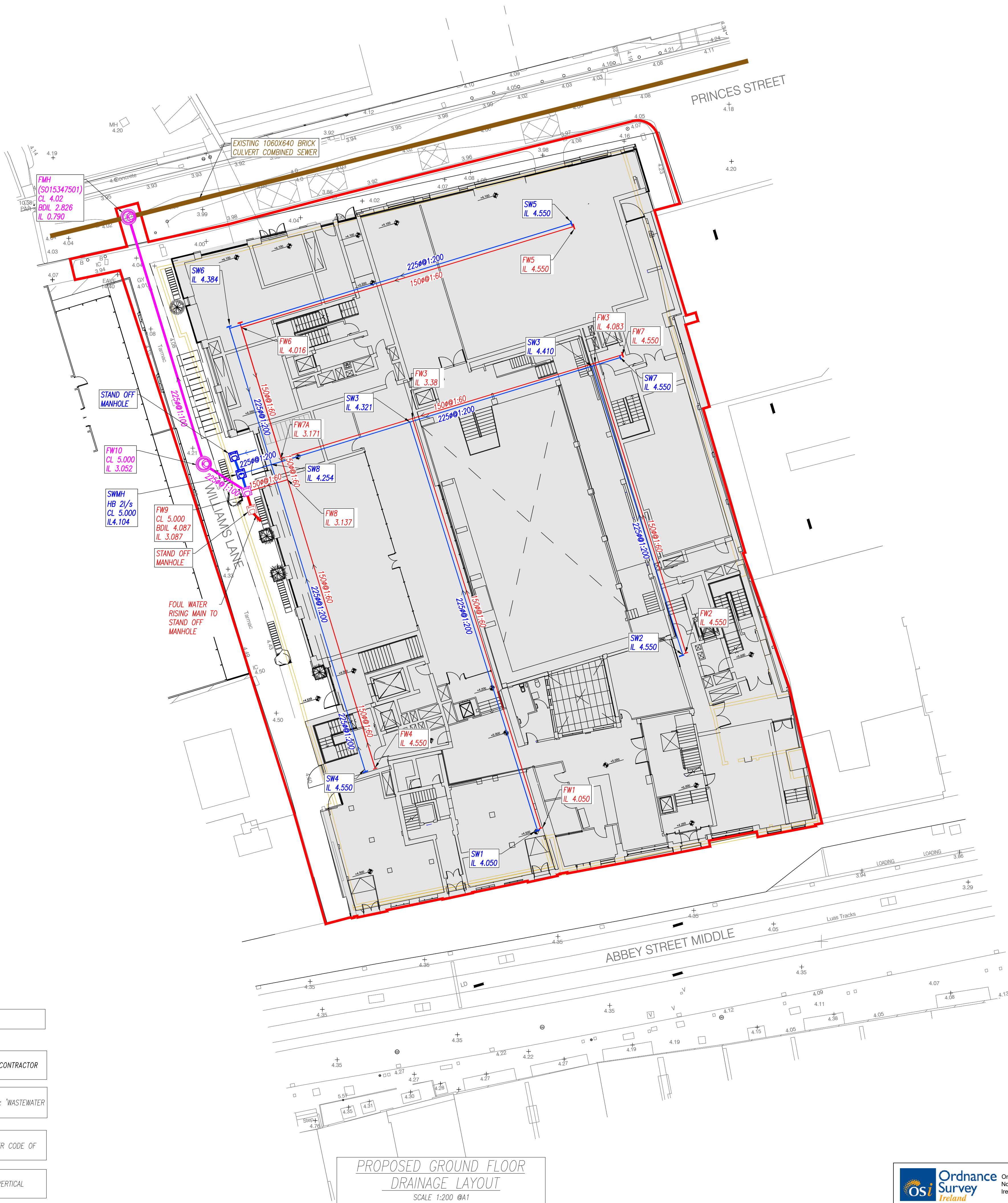

PROPOSED GROUND FLOOR
DRAINAGE LAYOUT
SCALE 1:200 @A1

Link Name	Section Type	Slope (1:X)	Cover Level (m)	Invert Level (m)	Length (m)
Link 1	225mm	1:100.0	4.300	4.290	4.777
Link 2	225mm	1:100.0	4.300	4.290	23.811

PROPOSED FOUL LONGSECTION
SCALE H 1:500 @A1

NOTE:
OFFSITE CONNECTIONS FOR FOUL WILL BE CARRIED OUT BY UISCE EIREANN AS PART OF CONNECTION AGREEMENT

NOTE:
CONTRACTOR TO CONFIRM POSITION AND INVERT OF ALL EXISTING SERVICES PRIOR TO COMMENCEMENT OF ANY WORKS. CONTRACTOR TO IMMEDIATELY INFORM ENGINEER IF ANY DISCREPANCIES ARE IDENTIFIED.

NOTE:
FOR DETAILS OF INSTALLATION PLEASE REFER TO IRISH WATERS 'CODE OF PRACTICE FOR WASTEWATER INFRASTRUCTURE' & 'WASTEWATER INFRASTRUCTURE STANDARD DETAILS'

NOTE:
PUBLIC FOUL PIPE MATERIAL TO BE U-PVC (STIFFNESS CLASS B) AND IN COMPLIANCE WITH SECTION 3.13 OF IRISH WATER CODE OF PRACTICE.

NOTE:
FOUL SEWERS TO BE CONSTRUCTED WITH CONCRETE SURROUND IN ACCORDANCE WITH IRISH WATER STD-WW-08 WHERE VERTICAL CLEARANCE FROM SURFACE WATER IS LESS THAN 300mm AND WHERE DEPTH OF COVER TO ROAD IS LESS THAN 1.2m

NOTES:

- DO NOT SCALE. USE FIGURED DIMENSIONS ONLY.
- THIS DRAWING IS TO BE READ IN CONJUNCTION WITH ALL OTHER RELEVANT ARCHITECTURAL AND ENGINEERING DRAWINGS.
- DRAINAGE DESIGN IS IN ACCORDANCE WITH:
 - RECOMMENDATIONS FOR SITE DEVELOPMENT WORKS FOR HOUSING AREAS PUBLISHED IN 1998;
 - GREATER DUBLIN STRATEGIC DRAINAGE STUDY (INCLUDING ATTENUATION OF SURFACE WATER FLOWS WHERE SPECIFIED);
 - BUILDING REGULATIONS;
 - CIVIL ENGINEERING SPECIFICATION FOR THE WATER INDUSTRY (CESWI);
 - IRISH WATER CODE OF PRACTICE FOR WASTEWATER INFRASTRUCTURE; AND
 - IRISH WATER CODE OF PRACTICE FOR WATER INFRASTRUCTURE.

LEGEND

- SITE BOUNDARY
- F1
CL 7.16
IL 5.15
150mm# @1:200
PROPOSED DUCTILE IRON FOUL WATER SEWER WITH PIPE SIZE, GRADE, MANHOLE REF. AND INVERT LEVEL
- S1
CL 7.16
IL 5.15
225mm# @1:200
PROPOSED SURFACE WATER SEWER WITH PIPE SIZE, GRADE, MANHOLE REF. AND INVERT LEVEL
- IC IC
INDICATES INSPECTION CHAMBER.
- F1
CL 7.16
IL 5.15
225mm# @1:200
INDICATES PROPOSED COMBINED FOUL SEWER WITH PIPE SIZE, GRADE, MANHOLE REF. AND INVERT LEVEL
- EX FMH
CL 0.00
IL 0.00
225mm# @1:200
INDICATES EXISTING COMBINED SEWER

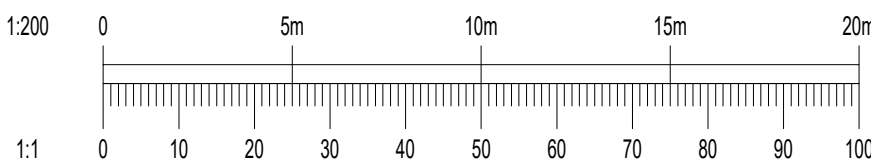

Rev	Date	Description	By	Chk
-----	------	-------------	----	-----

Amendments

Project
Independent House Student Accommodation
Middle Abbey Street
Dublin 1

Title
PROPOSED BASEMENT DRAINAGE LAYOUT

Client
SUMMIX IHD DEVELOPMENT LIMITED



BLOCK S, EASTPOINT BUSINESS PARK, ALFIE BYRNE ROAD,
DUBLIN D03 H3F4 IRELAND. Tel: (01) 864 8900
Email: info@waterman-moylan.ie www.waterman-moylan.ie

Status
FOR PLANNING ONLY

Designed By **BL** Approved **BG** Waterman Ref **24-036**

Drawn By **VU** Date **NOV. 2024** Scales @ A1 **1:200 @ A1**

Project - Originator - Volume - Level - Type - Role - Number - Revision

IHSA - WMC - ZZ - XX-DR- C -P210

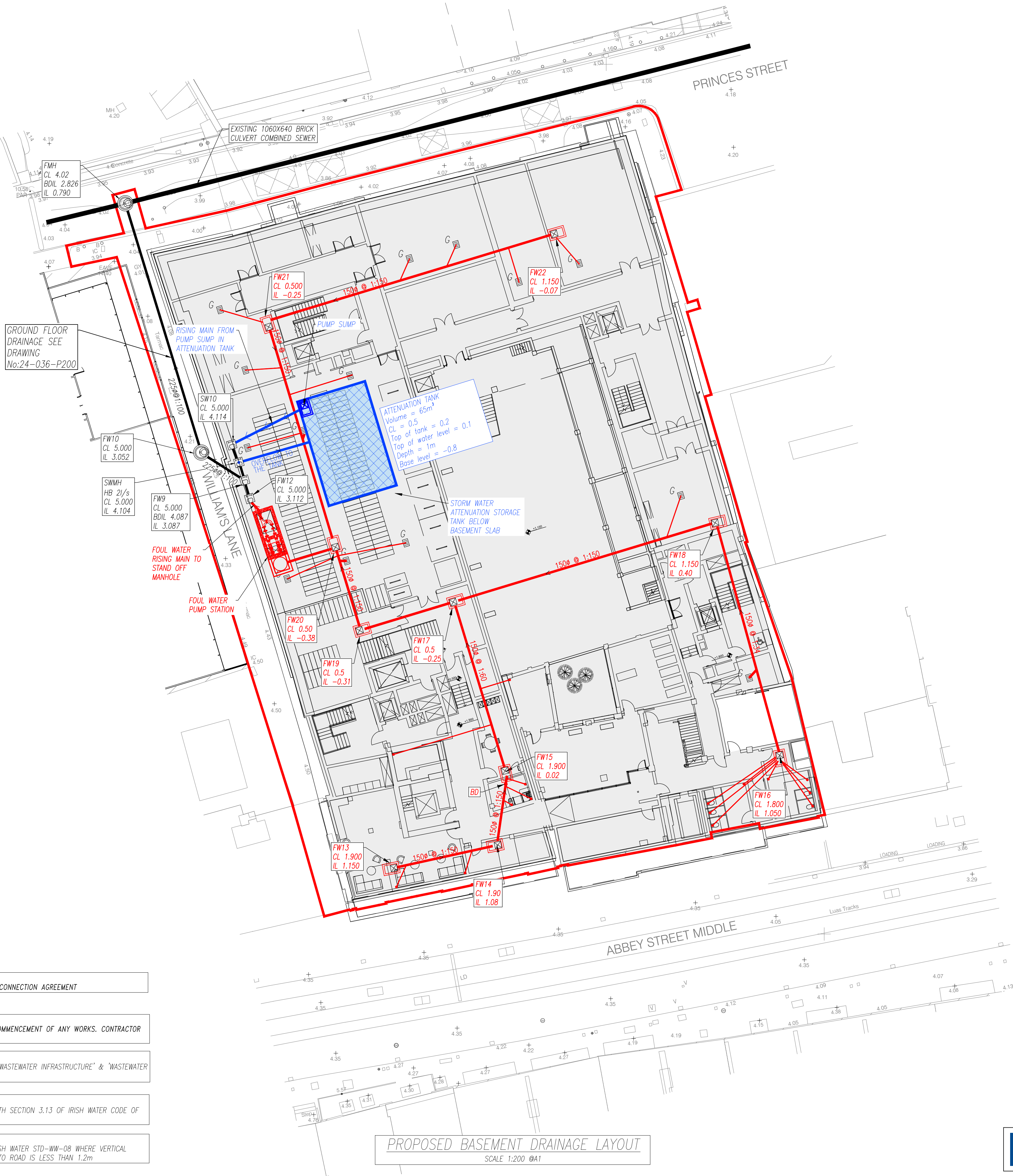

PROPOSED BASEMENT DRAINAGE LAYOUT
SCALE 1:200 @A1

NOTE:
OFFSITE CONNECTIONS FOR FOUL WILL BE CARRIED OUT BY UISCE EIREANN AS PART OF CONNECTION AGREEMENT

NOTE:
CONTRACTOR TO CONFIRM POSITION AND INVERT OF ALL EXISTING SERVICES PRIOR TO COMMENCEMENT OF ANY WORKS. CONTRACTOR TO IMMEDIATELY INFORM ENGINEER IF ANY DISCREPANCIES ARE IDENTIFIED.

NOTE:
FOR DETAILS OF INSTALLATION PLEASE REFER TO IRISH WATERS 'CODE OF PRACTICE FOR WASTEWATER INFRASTRUCTURE' & 'WASTEWATER INFRASTRUCTURE STANDARD DETAILS'

NOTE:
PUBLIC FOUL PIPE MATERIAL TO BE U-PVC (STIFFNESS CLASS B) AND IN COMPLIANCE WITH SECTION 3.13 OF IRISH WATER CODE OF PRACTICE.

NOTE:
FOUL SEWERS TO BE CONSTRUCTED WITH CONCRETE SURROUND IN ACCORDANCE WITH IRISH WATER STD-WW-08 WHERE VERTICAL CLEARANCE FROM SURFACE WATER IS LESS THAN 300mm AND WHERE DEPTH OF COVER TO ROAD IS LESS THAN 1.2m

This drawing should not be scaled. Dimensions to be verified on site.
Any discrepancies should be referred to the Engineer prior to work being put in hand.
This drawing is the property of Waterman Moylan Consulting Engineers Limited and is
issued on the condition that it is not copied, reproduced, retained or disclosed to any unauthorized person, either
wholly or in part without the consent in writing of
Waterman Moylan Consulting Engineers Limited
Block S East Point Business Park, Dublin D03 H3F4 Ireland
1-353 1 664 8900.

NOTES:

- DO NOT SCALE. USE FIGURED DIMENSIONS ONLY.
- THIS DRAWING IS TO BE READ IN CONJUNCTION WITH ALL OTHER RELEVANT ARCHITECTURAL AND ENGINEERING DRAWINGS.

LEGEND

— SITE BOUNDARY
EX XXXmm Ø WM — DENOTES EXISTING WATERMAIN

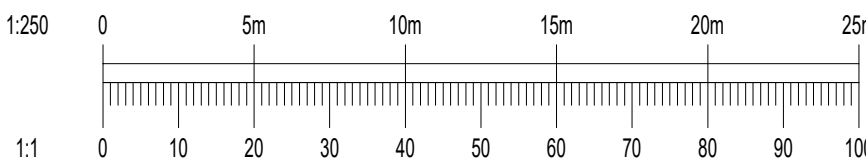

Rev	Date	Description	By	Chk
Amendments				

Project
Independent House Student Accommodation
Middle Abbey Street
Dublin 1

Title
PROPOSED WATERMAIN LAYOUT

Client
SUMMIX IHD DEVELOPMENT LIMITED



BLOCK S, EASTPOINT BUSINESS PARK, ALFIE BYRNE ROAD,
DUBLIN D03 H3F4 IRELAND. Tel: (01) 664 8900
Email: info@waterman-moylan.ie www.waterman-moylan.ie

Status
FOR PLANNING ONLY

Designed By	BL	Approved	BG	Waterman Ref	24-036
Drawn By	VU	Date	NOV. 2024	Scales @ A1	1:250 @ A1

Project	Originator	Volume	Level	Type	Role	Number	Revision
---------	------------	--------	-------	------	------	--------	----------

IHSA - WMC - ZZ - XX-DR- C - P300

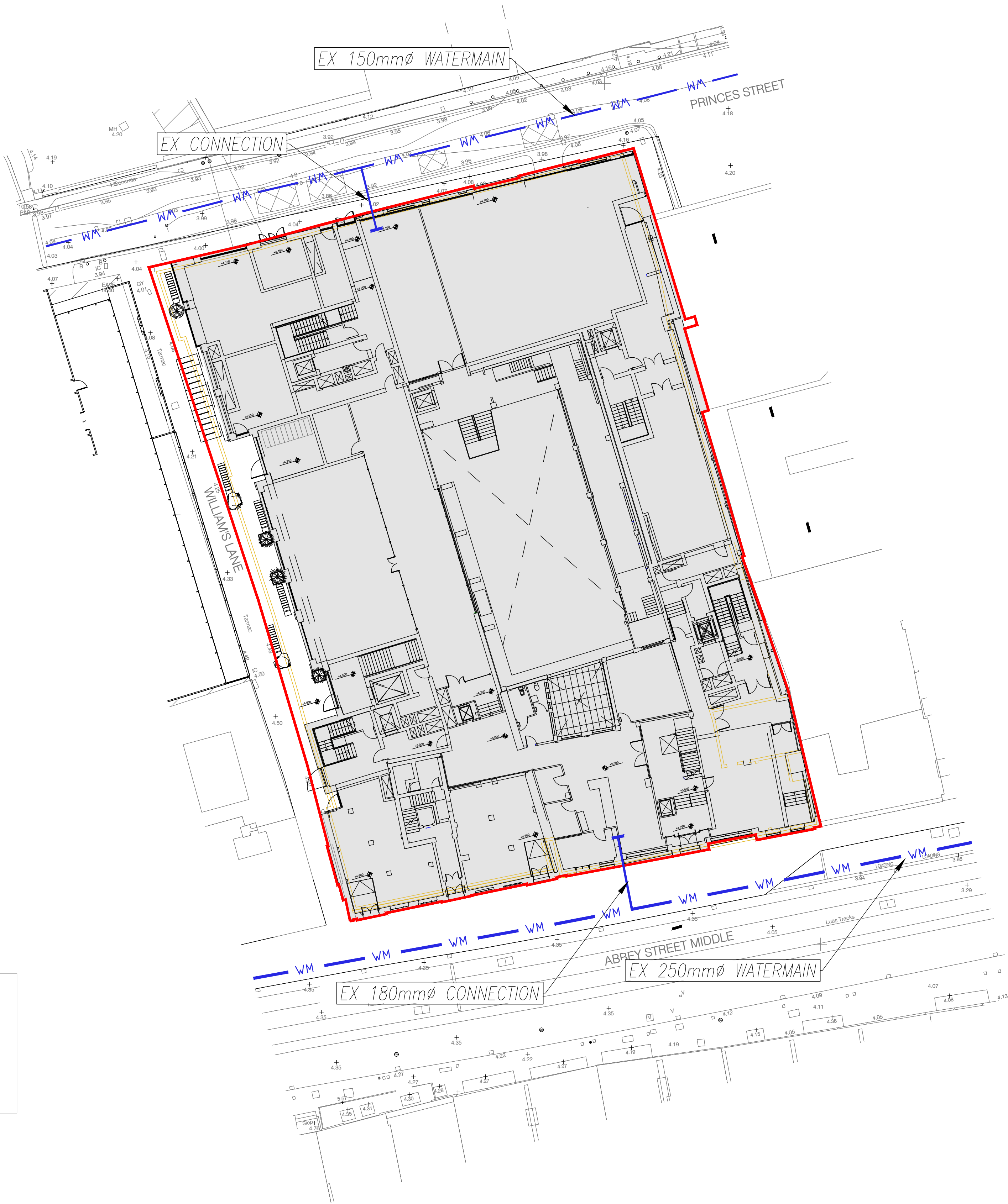

PROPOSED WATERMAIN LAYOUT
SCALE 1:250

NOTE:
IT IS ANTICIPATED THAT THE EXISTING
WATER SUPPLY CONNECTIONS WILL BE
REUSED TO SERVICE THE PROPOSED
DEVELOPMENT